

For Lease

RESOURCE
REAL ESTATE PARTNERS

GWINNETT PROGRESS CENTER

2150 Cedars Road, Suite 1000, Lawrenceville, Georgia



5,600 S.F. AVAILABLE

PROPERTY INFORMATION:

- 5,565 SF available
- 2,807 SF office
- One (1) 9'x10' dock door
- One (1) 10'x12' drive-in door
- 24' minimum clear height
- 5' concrete slab, 4,000 PSI
- Fully sprinklered - Class IV System
- 120' truck court, 55' concrete apron
- 16 parking spaces per 1,000 RSF, expandable
- Located within Gwinnett Progress Center, a 1,500 acre, master-planned business park

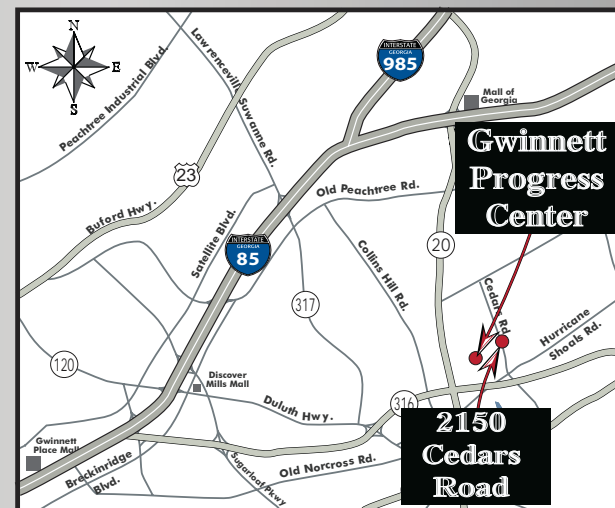

CONTACT INFORMATION:

Nathan Pramik
770-436-4553

npramik@resourcere.com

Mark Hawks
770-436-7196

mhawks@resourcere.com

Matt Nelsen
770-436-6016

mnelsen@resourcere.com

For Lease

2150 CEDARS ROAD, SUITE 1000

LAWRENCEVILLE, GEORGIA

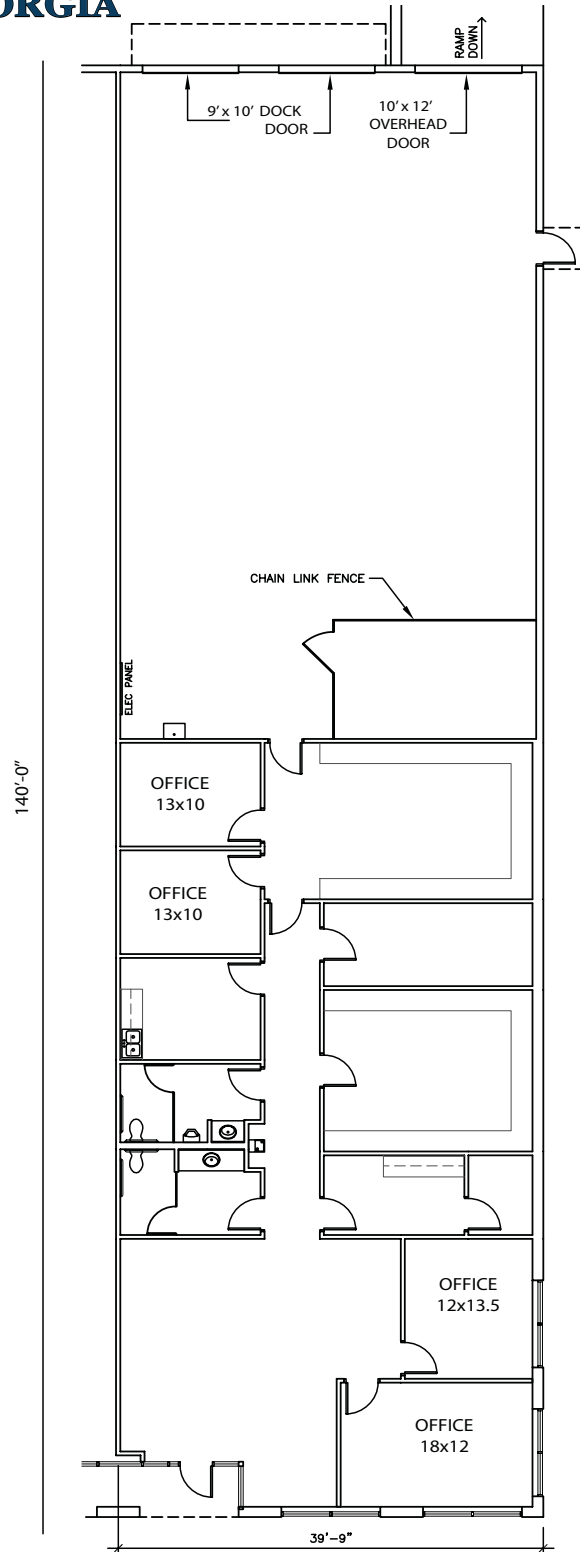

Total Building:	72,800 SF
Total Premises:	5,565 SF
Office:	2,807 SF
9' x 10' Dock High Doors:	2
10' x 12' Drive-In Doors:	1



Owned & Managed by:

MERITEX®